

BAGNODESIGN

EXPERTLY CRAFTED BATHROOMS

General Installation Guide

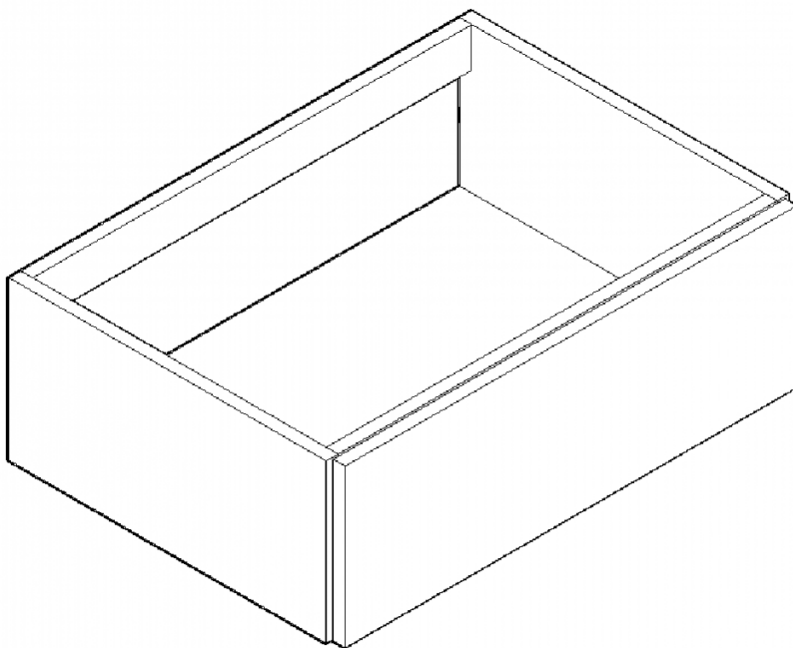

MONROE

Wall mounted vanity basin unit 700, 900 & 1200

NOTE: Countertop wash basin not included, it is only used for illustrative purposes.

A member of SANIPEXGROUP

Please leave these instructions with the customer

IMPORTANT PLEASE READ

Remove all packaging and check the product for missing parts or damage before starting installation.

Any alterations made to this product and fittings may infringe water regulations and invalidate the guarantee.

The Installation must comply with all Local/National Water Supply Authority Regulations/Byelaws and Building and Plumbing Regulations.

We strongly recommend that your product be installed by a reputable qualified trade's person.

General Installation:

Please note this product can require 2 or more persons to lift and manoeuvre into position.

To the installer: Please read and follow this instruction carefully, as the guarantee is only valid if the product is installed as directed.

Don't rush, read the instructions first and run through them before you begin. Keep fittings together to avoid loss. Do not over tighten screws or bolts.

If the unit is covered with polyethylene protective film, do not remove until installation is complete to grant maximum protection. However, remove film where any two surfaces will be in permanent contact.

Verify that all dimensions on the plan are the same as the ones of the product.

Please leave this installation manual with the end user once the product has been installed.

Product Aftercare:

We recommend cleaning with a soft damp cloth and mild soap solution.

Do not use cream cleaners or cleaners containing bleach.

Do not scrub or scour.

Do not use abrasive cleaning agents.

Do not use solvent based cleaners.

Do not allow pools of water to remain standing on the surfaces

TOOLS REQUIRED (Not supplied)

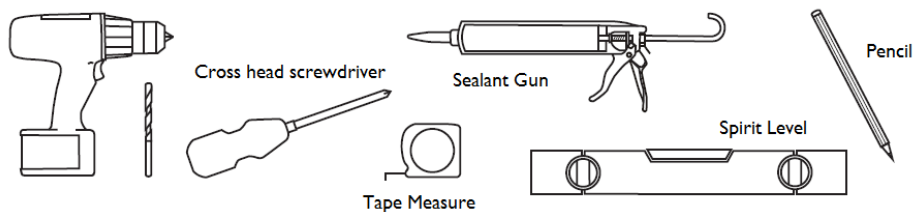

Drill and drill bits

Required when securing the cabinet to a wall. Use an appropriate size bit to match the wall fixing chosen (wall screws and fixings not supplied).

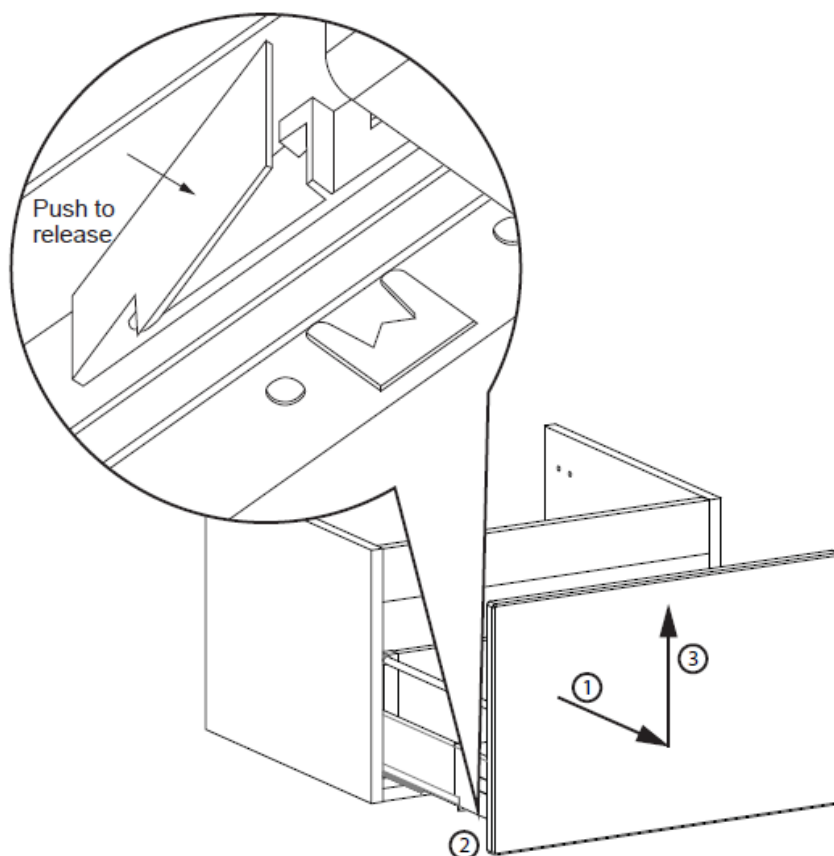

To make installation easier it is recommended that you remove the drawer from the cabinet. With both hands at each side of the drawer reach under the base of the drawer sides at the front and feel for the release mechanisms. Push the plastic clips inwards and at the same time lift the drawer unit up clear of the runners.

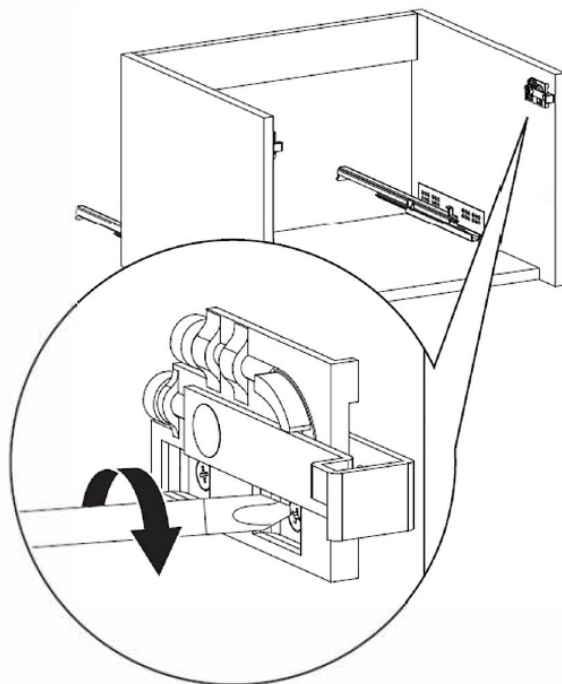

Remove the wall cabinet hangers from the packaging and fit them to the correct corresponding sides of the cabinet. The cabinet hangers are fitted to the sides of the cabinet using a cross headed screwdriver and the fixing screws supplied in the cabinet hanger pack as shown above.

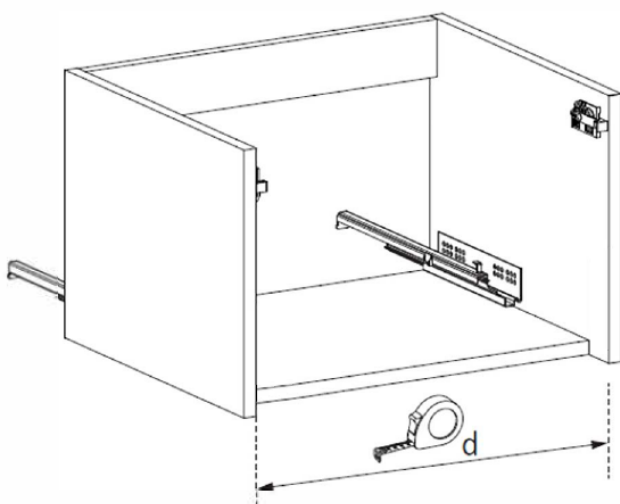

Using a tape measure, measure the internal distance between the 2 end panels.

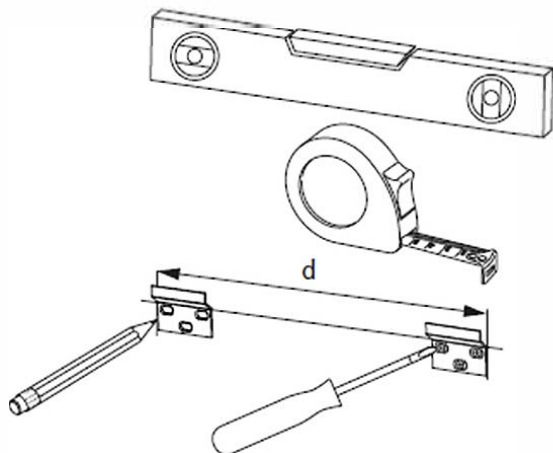

Once you have decided on a suitable position for your vanity unit, mark out the internal distance onto the wall. Line the wall fixing plates up to the inside of the markings and mark out the drilling positions on the wall. Attach wall fixing plates using suitable fixings (not supplied), making sure the wall fixing plates are level and the distance between the outer edges of the wall fixing plates is the same as that measure in the previous stage.

Note:- It is good practice to fit all pipework and plumbing before fixing the unit to the wall to enable easier installation and fitting.

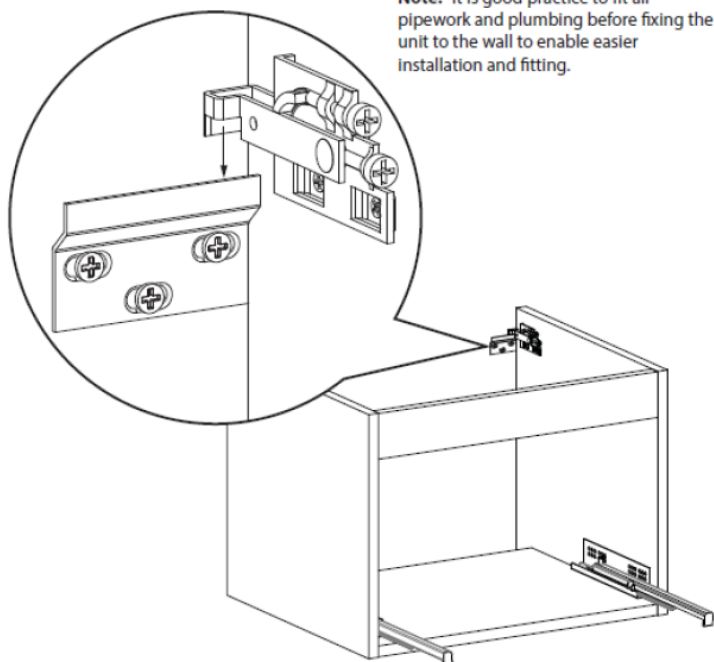

Gently lift the cabinet into position so that the cabinet hangers sit onto the wall brackets. Make sure that the cabinet is securely held in place before letting go.

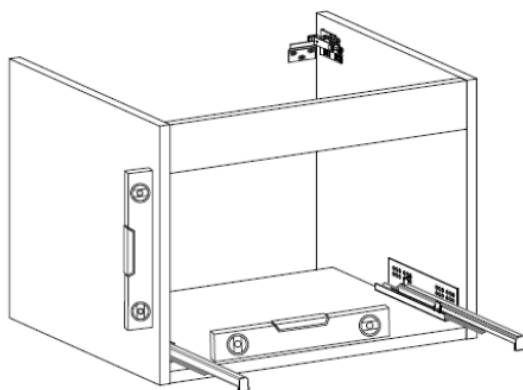

Using a spirit level check the cabinet is level and plumb. Adjust the cabinet hanger as shown, using the top screw to alter the vertical adjustment and the bottom screw to secure the unit to the wall once the unit is level.

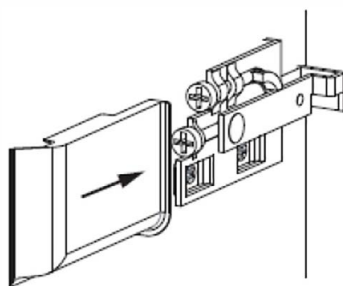

Once you are happy that the unit is level place the covers over the cabinet hangers.

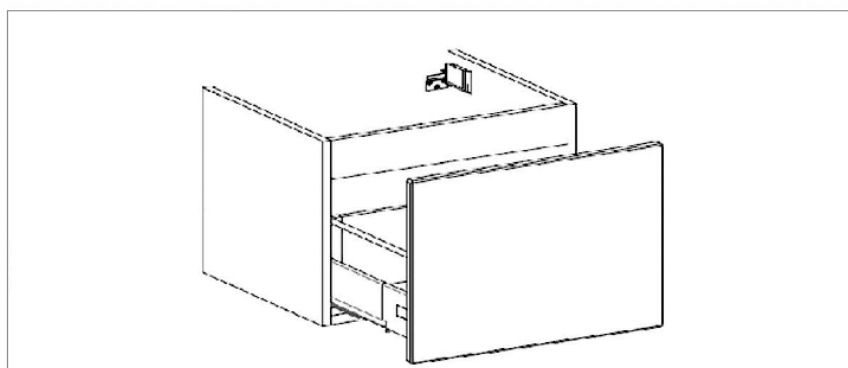

When you are happy with the position of the cabinet, using suitable wall fixings (not supplied), fix the cabinet through the brackets at the base of the unit.

Put the drawer box back into the unit. Fully extend the drawer runners and lower the drawer onto the runner pushing it closed, the drawer will click into place.

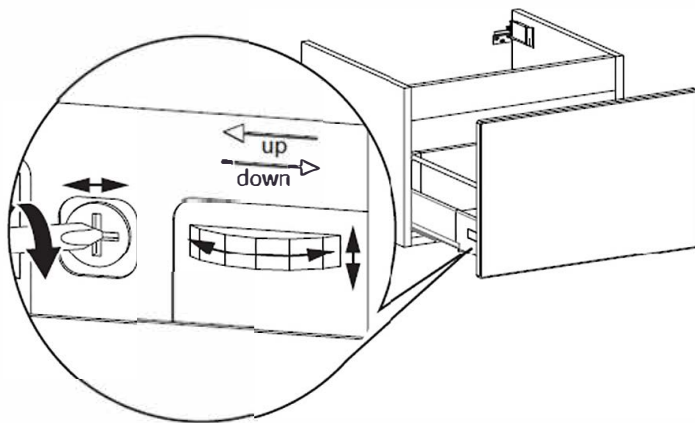

If you need to adjust the drawer unit this can be achieved by removing the plastic cover caps from the drawer sides to reveal the adjustment wheel and screw. Please follow the diagrams below to adjust the drawer in both the Vertical and horizontal planes. Please note horizontal adjustment can only be made from the RH drawer side. When adjustment has been made replace the plastic cover caps by gently pushing back into place.

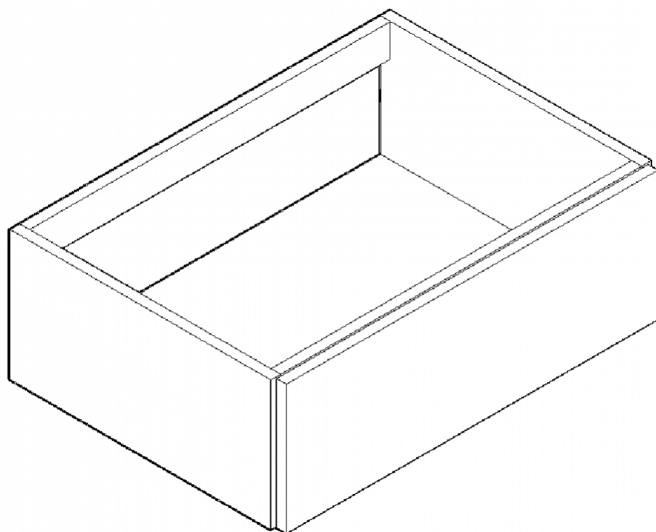

Install the wash basin (not supplied) as per the basin installation guide.

INSTALLATION COMPLETE!!

BAGNODESIGN

EXPERTLY CRAFTED BATHROOMS

Oakwell Way, Birstall
Leeds, England WF9 17LU

A member of  SANIPEXGROUP